

**ZONING CASE NUMBER 2014-00008-(4)**

**ORDINANCE NO. 2016-0063Z**

An ordinance amending Section 22.16.230 of Title 22 of the County Code, changing regulations for the execution of the Rowland Heights Community Plan, a component of the County General Plan relating to the Puente Zoned District Number 76.

The Board of Supervisors of the County of Los Angeles ordains as follows:

**SECTION 1.** Section 22.16.230 of the County Code is amended by amending the map of the Puente Zoned District Number 76, as shown on the map attached hereto.

**SECTION 2.** The Board of Supervisors finds that this ordinance is consistent with Rowland Heights Community Plan, a component of the County General Plan.

CHANGE OF PRECISE PLAN  
 PUENTE ZONED DISTRICT

**ADOPTED BY ORDINANCE:** 2016-0063Z  
**ON:** NOVEMBER 22, 2016  
**ZONING CASE:** ZC201400008

AMENDING SECTION: 22.16.230 OF THE COUNTY CODE

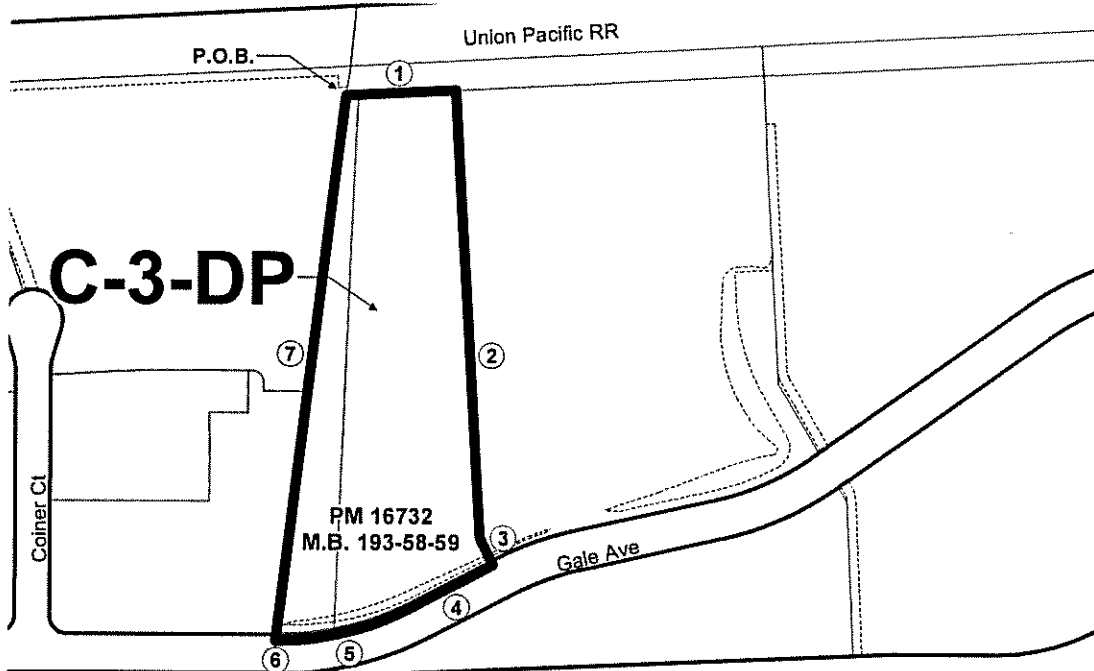

**LEGAL DESCRIPTION:**

THAT PORTION OF THE "REMAINDER PARCEL" AS SHOWN ON PARCEL MAP NO. 16732, IN THE UNINCORPORATED TERRITORY OF THE COUNTY OF LOS ANGELES, STATE OF CALIFORNIA, AS PER MAP FILED IN BOOK 193, PAGES 58 AND 59 OF PARCEL MAPS, IN THE OFFICE OF THE COUNTY RECORDER OF SAID COUNTY, BEING ALSO ALL OF CERTIFICATE OF COMPLIANCE RCOC 2015 00159, RECORDED MARCH 8, 2016 AS INSTRUMENT NO. 20160253307 TOGETHER WITH A PORTION OF CERTIFICATE OF COMPLIANCE RCOC 2015 00158, RECORDED MARCH 8, 2016 AS INSTRUMENT NO. 2016D253306, BOTH OF OFFICIAL RECORDS OF SAID COUNTY, DESCRIBED AS FOLLOWS:

- BEGINNING AT THE NW. CORNER OF SAID "REMAINDER PARCEL";
- ① N.86° 45' 36"E., 184.00';
  - ② S.03° 14' 24"E., 754.48';
  - ③ S.27° 23' 57"E., 50.29' TO THE S'LY LINE OF SAID "REMAINDER PARCEL";
  - ④ S.62° 36' 58"W., 165.50' TO THE BEGINNING OF A TANGENT CURVE, CONCAVE NW'LY AND HAVING A RADIUS 467.00';
  - ⑤ SW'LY ALONG SAID CURVE, THROUGH A CENTRAL ANGLE OF 27° 11' 37" AN ARC LENGTH OF 221.65';
  - ⑥ S.89° 48' 35"W., 2.83' TO THE SW. CORNER OF SAID "REMAINDER PARCEL";
  - ⑦ ALONG THE W'LY LINE OF SAID "REMAINDER PARCEL", N.07° 03' 58"E., 922.99' TO THE POINT OF BEGINNING.

PARCEL CONTAINS: 231,214 SQ. FT. OR 5.308 ACRES MORE OR LESS.

**LEGEND:**

- PARCELS
- STREET / RIGHT OF WAY
- LOT LINE
- CUT/DEED LINE
- EASEMENT LINE
- ZONE CHANGE AREA
- NAP** NOT A PART

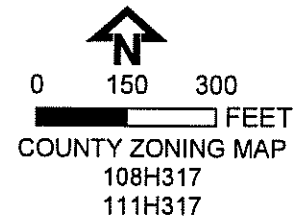

**DIGITAL DESCRIPTION:** \ZCO\ZD\_PUENTE\

THE REGIONAL PLANNING COMMISSION  
 COUNTY OF LOS ANGELES  
 LAURA SHELL, CHAIR  
 RICHARD J. BRUCKNER, PLANNING DIRECTOR

SECTION 3. This ordinance shall be published in The Daily Commerce a newspaper printed and published in the County of Los Angeles.



Hilda J. Solis  
Chair

ATTEST:

Lori Glasgow

Lori Glasgow  
Executive Officer -  
Clerk of the Board of Supervisors  
County of Los Angeles

I hereby certify that at its meeting of November 22, 2016 the foregoing ordinance was adopted by the Board of Supervisors of said County of Los Angeles by the following vote, to wit:

<u>Ayes</u>		<u>Noes</u>	
Supervisors	<u>Hilda Solis</u>	Supervisors	<u>None</u>
	<u>Mark Ridley-Thomas</u>		
	<u>Sheila Kuehl</u>		
	<u>Don Knabe</u>		
	<u>Michael D. Antonovich</u>		

Effective Date: December 22, 2016

Operative Date: \_\_\_\_\_

Lori Glasgow

Lori Glasgow  
Executive Officer -  
Clerk of the Board of Supervisors  
County of Los Angeles

I hereby certify that pursuant to Section 25103 of the Government Code, delivery of this document has been made.

LORI GLASGOW  
Executive Officer  
Clerk of the Board of Supervisors

By [Signature]  
Deputy



APPROVED AS TO FORM:  
MARY C. WICKHAM  
County Counsel

By [Signature]  
Lester J. Cornai  
Chief Deputy County Counsel